



Chanvrière du Belon
Chanvre & Techniques



Industrial hemp All products



Chanvrière du Belon Hemp products

Seeds

Oil

Flour

Essential Oil

Beverage

Building materials

Insulation

Fiber



All products



" Cultivating your sense of confort "



La Chanvrière du Belon a hemp operator in French Cornwall.

Our cooperative structure organises a part of hemp cultivation in France in collaboration with certified organic farmers. Hemp, one of the first plant ever to be grown, possesses numerous qualities and can be used in many different areas (textile, paper-making, cosmetics, foodstuffs, building...).

In particular, given the rot-proof nature of hemp plant fibres and the insulating properties of the plant, we were able to develop a building technique for modern, comfortable housing. The patented process is based on the « cob » building technique, where a plant is mixed with a binder. With our transformation process, the integrity of plant fibres is preserved, giving the material perfect cohesion and outstanding mechanical strength.

« Hemp in building »

Hempwool TECHNICHANVRE
for insulation



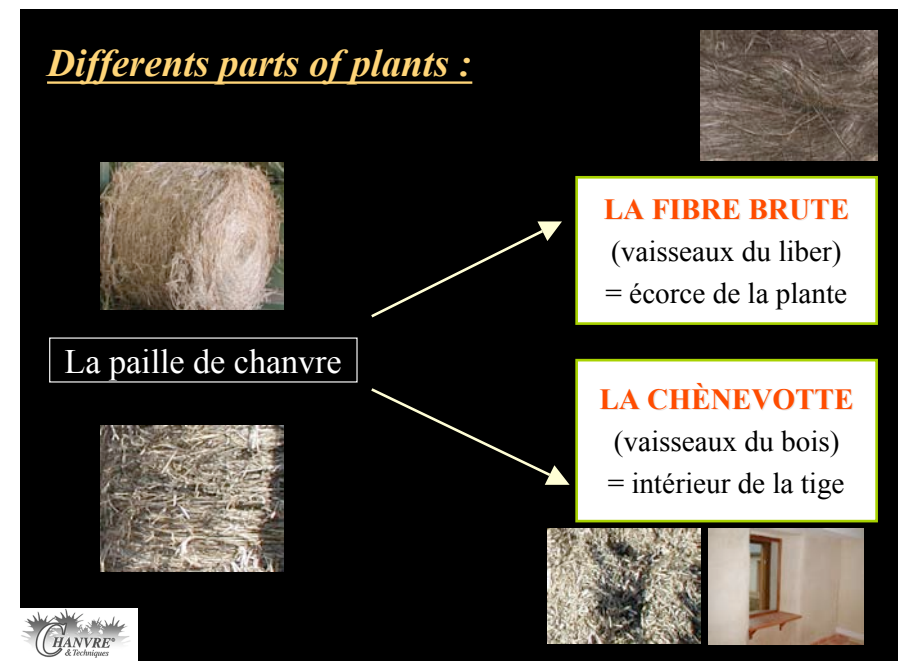
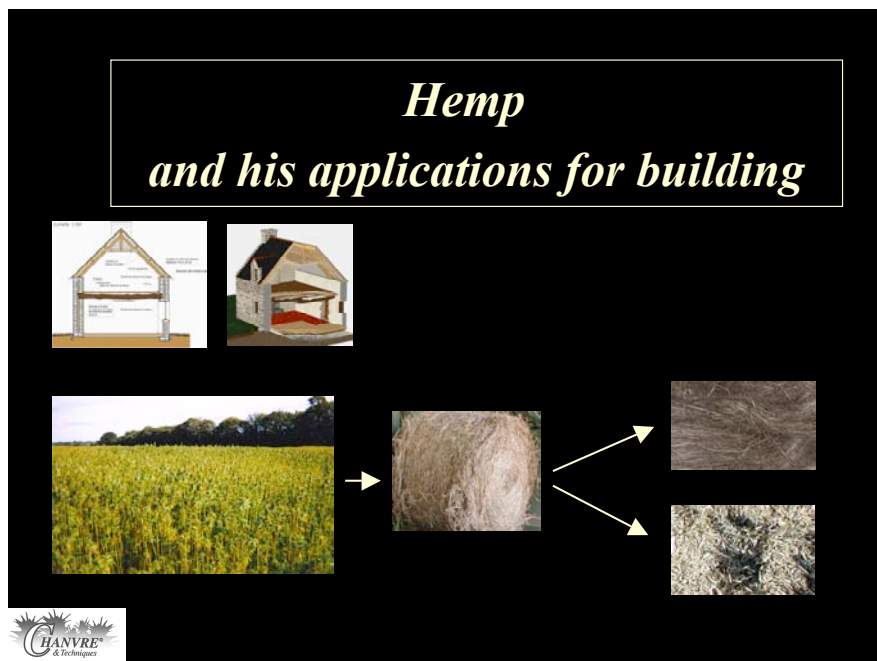
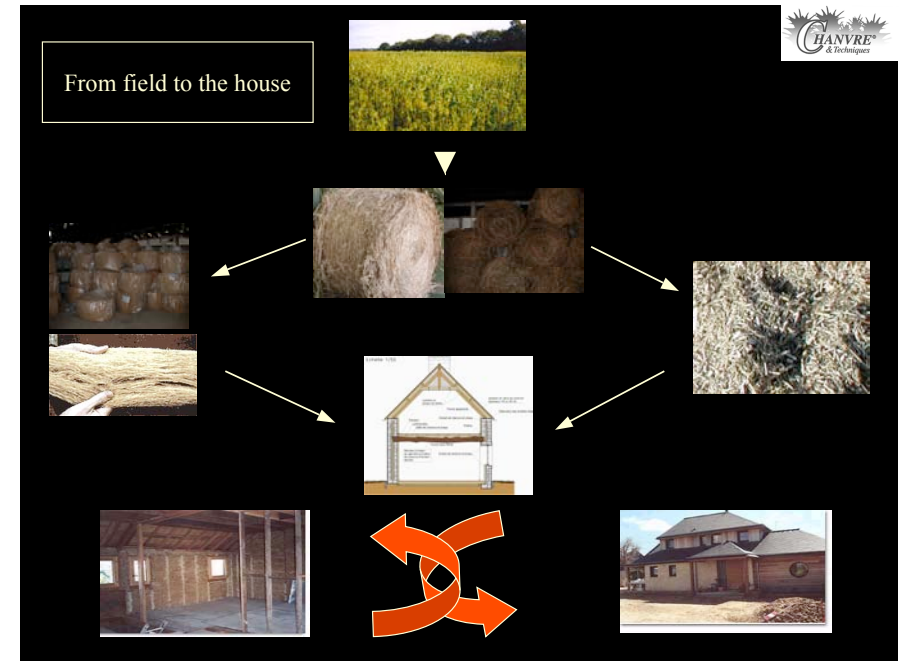
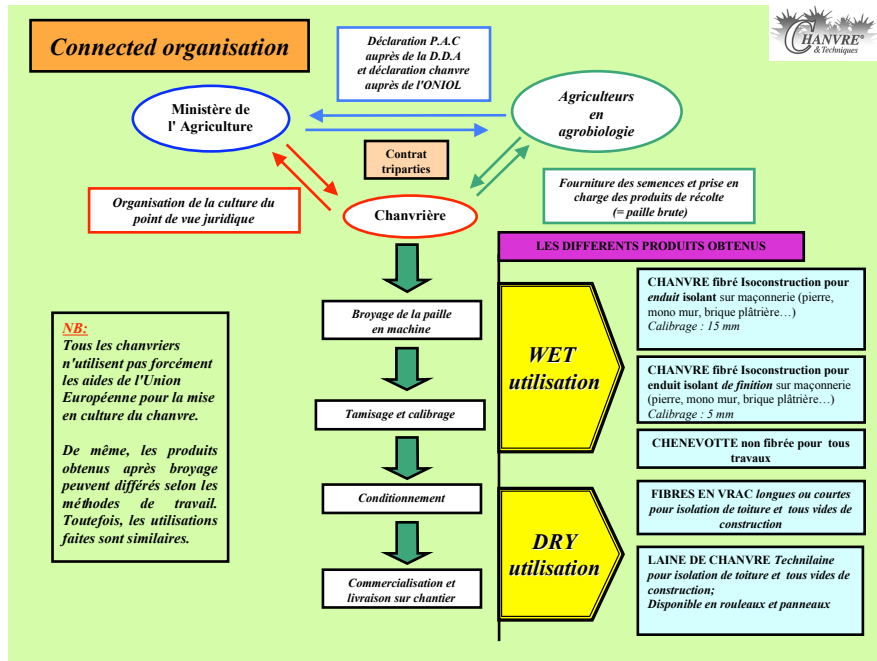

Utilisations of hemp materials in houses



Utilisations of hemp materials in houses

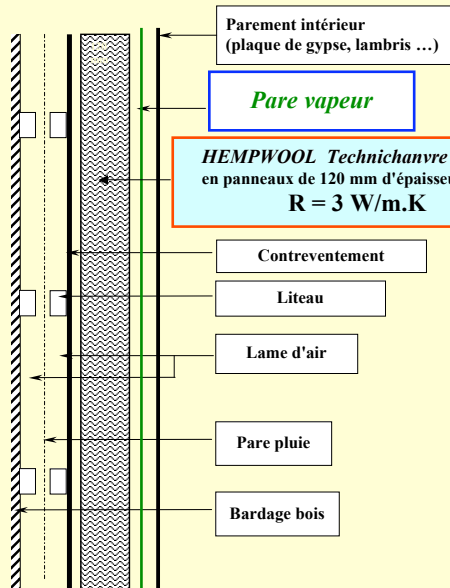
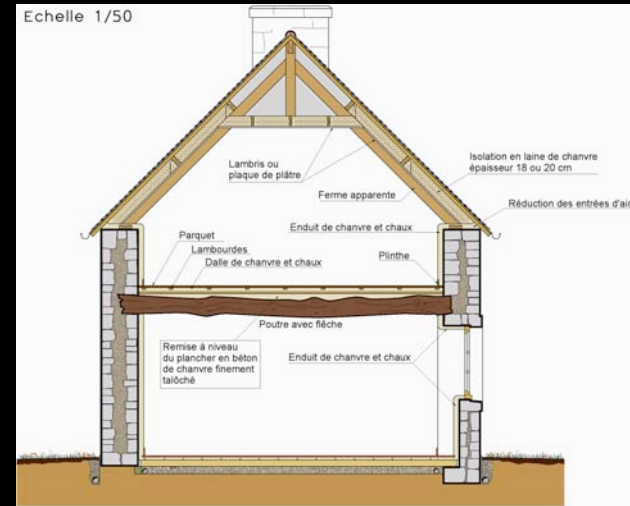

Wood houses
entraxe 60 cm idéalement
peripheric wall

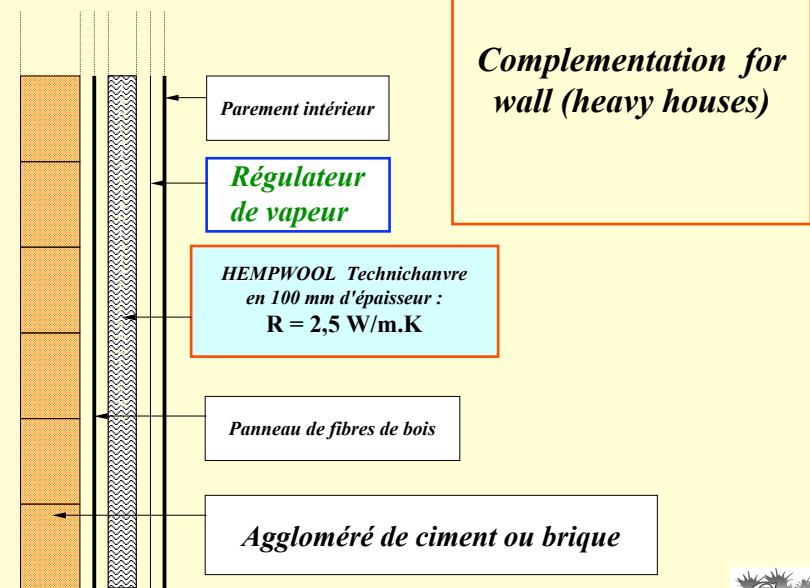

Complementation for wall (heavy houses)

Hempwoll : rolls and mat



$\lambda = 0,04 \text{ W/m.K}$

Dimensions et types d'utilisations selon les produits

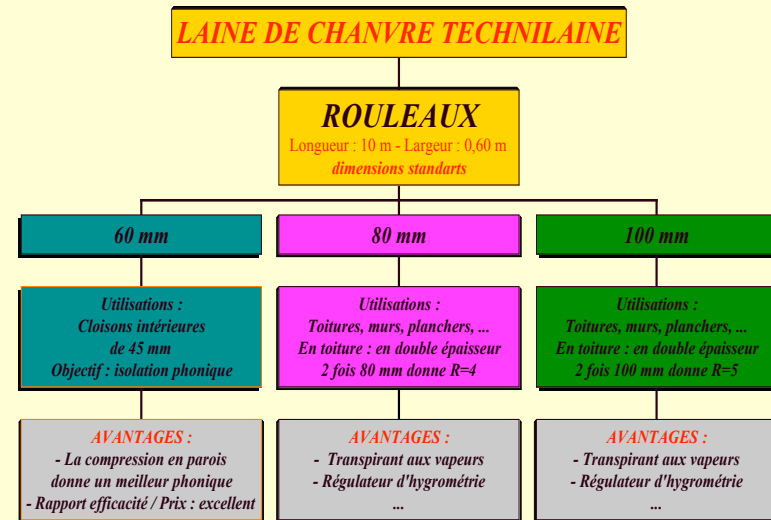

Dimensions et types d'utilisations selon les produits

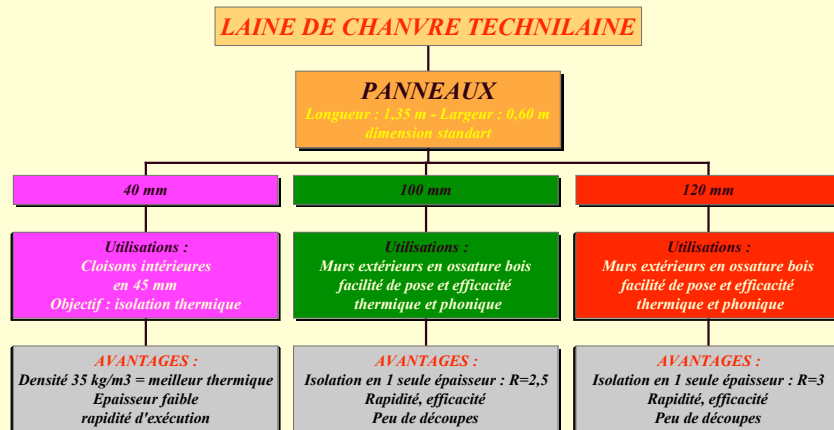

Données supplémentaires

- Légère protection au feu
- Certifications CSTB courant 2005
- Grande résistance à l'eau
- Adaptation des épaisseurs aux zones climatiques
- Crédibilisation produit avec l'arrivée d'ISOVER
- Qualité supérieure : une seule fibre végétale
- Adaptation à la demande (largeur... / volumes)

MARKET TODAY

- Demand increase rapidly
- Target : eco-building
- Cost : 4 times the mineral insulation
- it's not a brake to developpement because insulation is only 1% of total cost of construction.

Saint Gobain - ISOVER

- Present on the market
- Create a good confidence to the professionals
- European regulation (CUAP) has accepted hemp as insulation material
- Credibilisation of product
- give a good bild
- Good media return

PRODUCTION TODAY

3 numbers

➤ **3,000 Tons** of fibres giving



Giving

120,000 m³



Giving

1,200,000 sq m

TOMORROW (2005)

- Probably multiply by 1,5

4,500 tons of fibres



Means

10 % of total production

AND LATER ...

*Is the production ready to
provide 8,000 tons in very
short time ??*

« Hemp in building »

*Hempwool TECHNICHANVRE
for insulation*



Found all informations



on our website :

www.technichanvre.com